

BROWNING AVENUE

( By Registered Plan M-368 )

P.I.N. 10403-0118

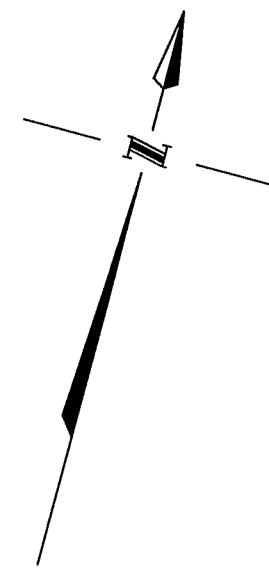

**RECEIVED**  
 By TEY CoFA at 9:23 am, Mar 14, 2017

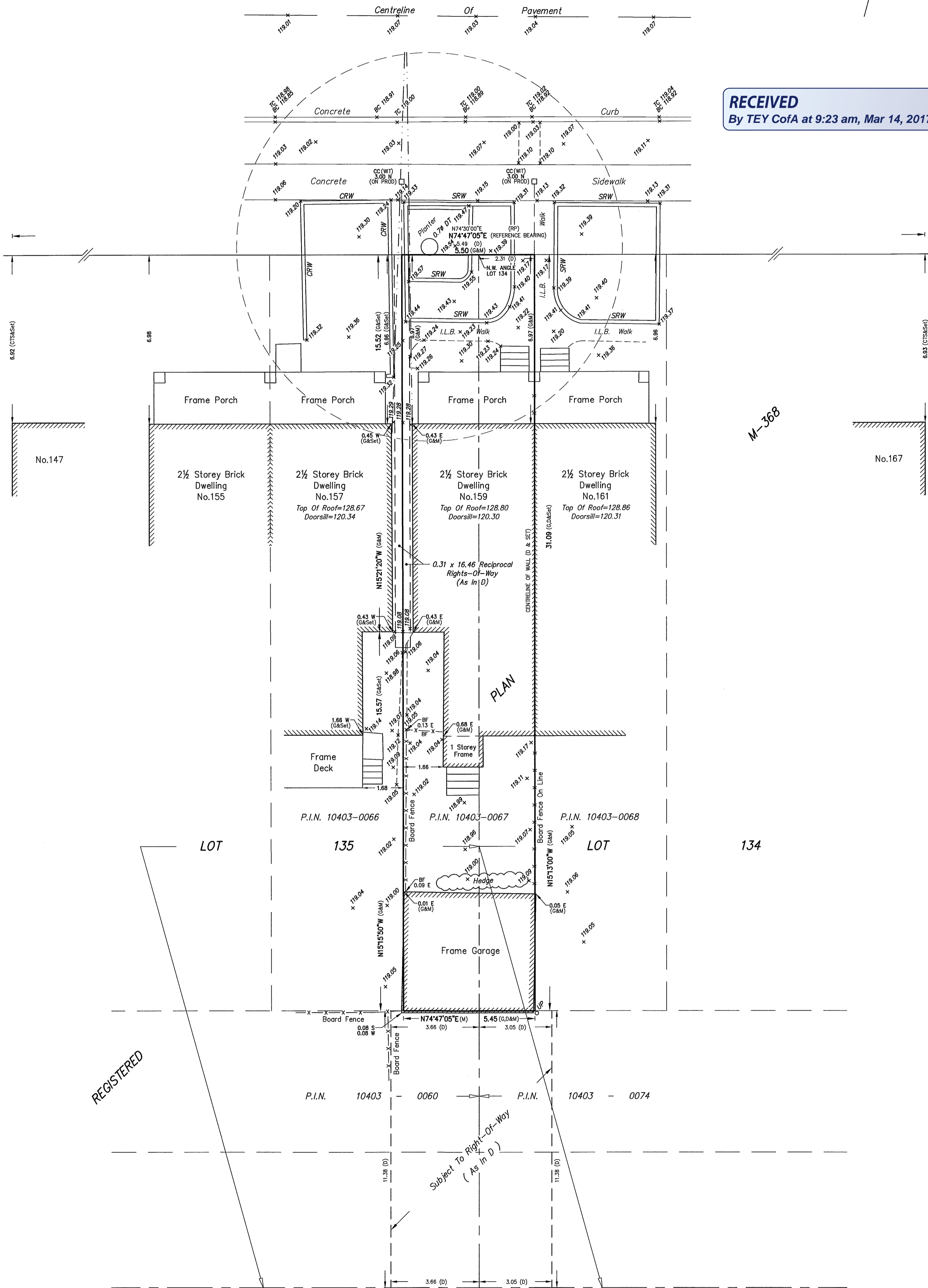

**METRIC**  
 DISTANCES SHOWN ON THIS PLAN ARE IN METRES AND CAN BE CONVERTED TO FEET BY DIVIDING BY 0.3048.

**SURVEYOR'S CERTIFICATE**  
 I CERTIFY THAT:  
 1. THIS SURVEY AND PLAN ARE CORRECT AND IN ACCORDANCE WITH THE SURVEYS ACT, THE SURVEYORS ACT AND THE REGULATIONS MADE UNDER THEM.  
 2. THE SURVEY WAS COMPLETED ON THE 3rd. DAY OF JANUARY, 2017.

JANUARY 25, 2017  
 DATE

*Chris Beresniwicz*  
 CHRIS BERESNIWICZ  
 ONTARIO LAND SURVEYOR

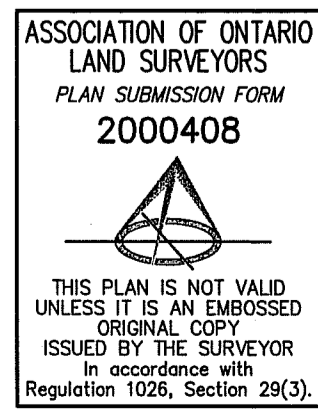

**LEGEND**

- DENOTES SURVEY MONUMENT SET
- RP REGISTERED PLAN M-368
- N,S,E,W NORTH,SOUTH,EAST, WEST
- M MEASURED
- CC CUT CROSS
- PROD PRODUCTION
- WT WITNESS
- OVERHEAD WIRES
- UP UTILITY POLE
- ILB INTERLOCKING BRICK
- P.I.N. PROPERTY IDENTIFIER NUMBER
- D PARCEL 1505, SECTION P TORONTO
- CTS CITY OF TORONTO SURVEYS
- G PLAN BY W. S. GIBSON, O.L.S. DATED AUGUST 30, 1990

**LEGEND (Cont...)**

- BF DENOTES BOARD FENCE
- CRW CONCRETE RETAINING WALL
- SRW STONE RETAINING WALL

**ELEVATION NOTE**  
 ELEVATIONS ARE GEODETIC AND ARE REFERRED TO THE CITY OF TORONTO BENCHMARK NO. 12020020003, HAVING A PUBLISHED ELEVATION OF 120.22 METRES.

**BEARING NOTE**  
 BEARINGS ARE GRID BEARINGS AND ARE REFERRED TO THE SOUTHERLY LIMIT OF BROWNING AVENUE, HAVING A BEARING OF N74°47'05\"/>

THIS PLAN WAS PREPARED FOR OLIVER DANG.

**PART 2 - SURVEY REPORT**

- 1) PLEASE NOTE LOCATION OF FENCES AND OVERHEAD WIRES
- 2) REGISTERED EASEMENTS AND/OR RIGHTS-OF-WAY : SUBJECT TO AND TOGETHER WITH RIGHTS-OF-WAY AS IN PARCEL 1505, SECTION P, TORONTO
- 3) THIS PLAN DOES NOT CERTIFY COMPLIANCE WITH ZONING BY-LAWS

**Young & Young Surveying**  
 (ETOBICOKE 2006) INC.  
 310 North Queen St., Suite 102, Toronto ON M9C 5K4  
 Tel: (416) 621-2676 - Fax: (416) 621-3360  
 E-MAIL : info@youngandyoung.ca